

THIS DRAWING IS UNPUBLISHED. RELEASED FOR PUBLICATION
 © COPYRIGHT BY TYCO ELECTRONICS CORPORATION. ALL RIGHTS RESERVED.

LOC	DIST	REVISIONS					
CM	00	P	LTR	DESCRIPTION	DATE	DWN	APVD
		E		ECO-07-012878	19JUN07	KW	DB

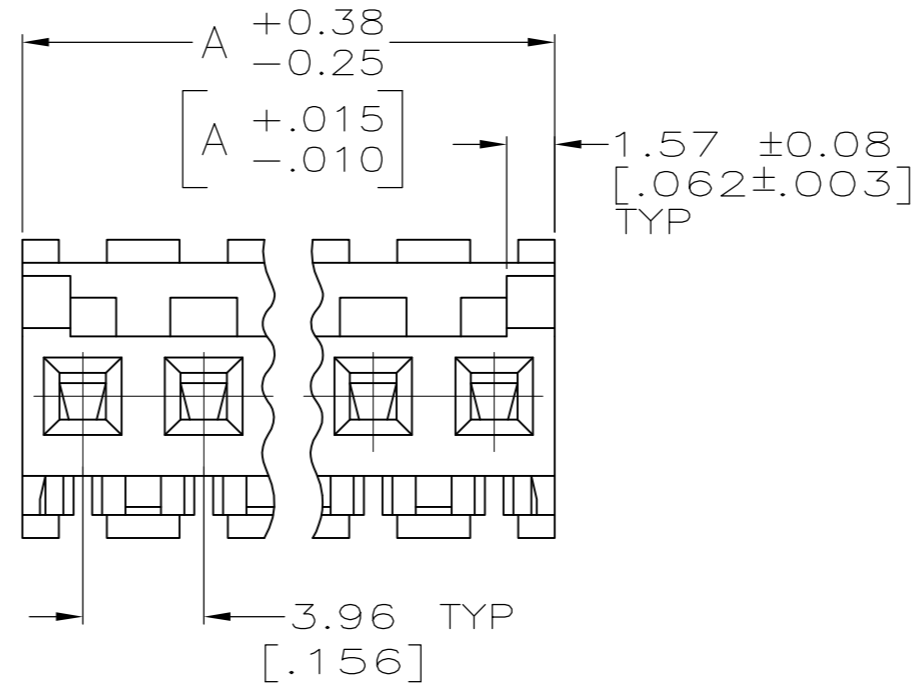
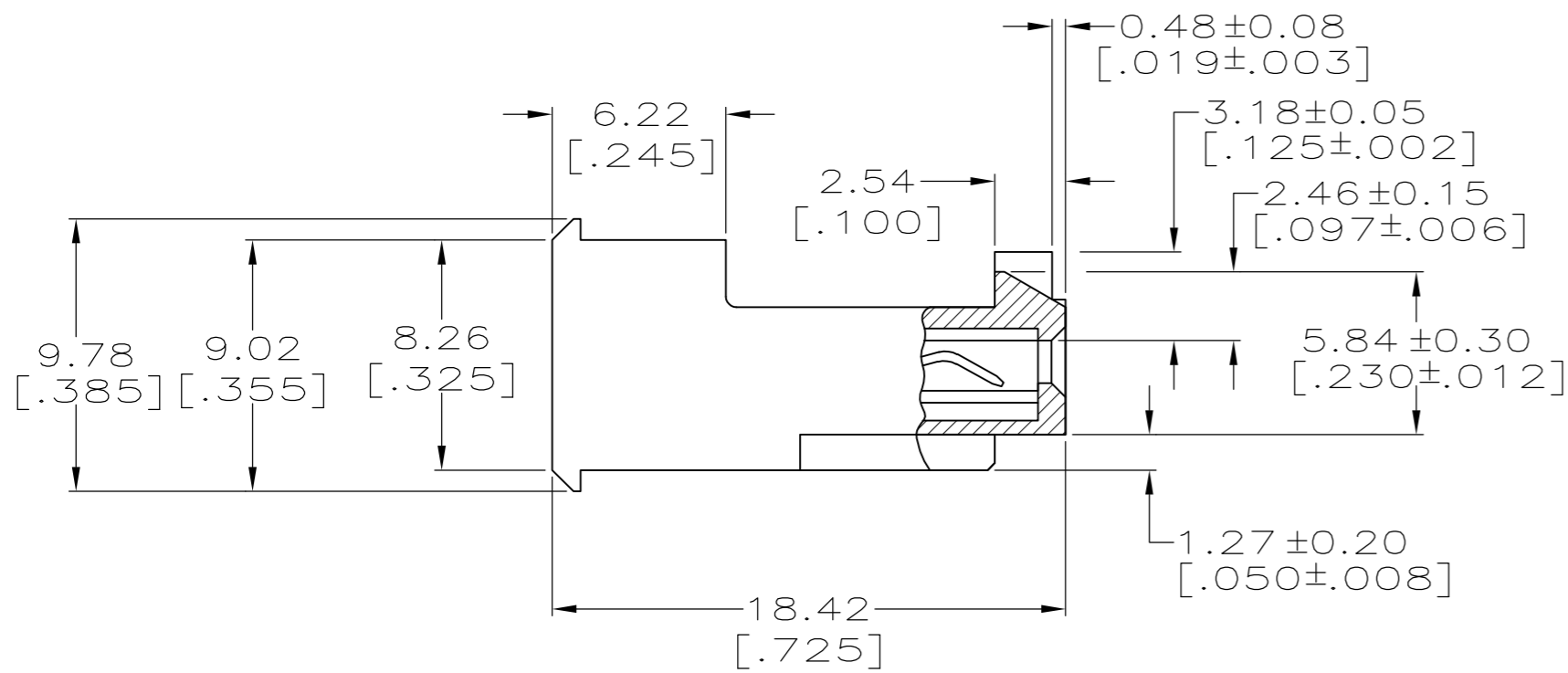
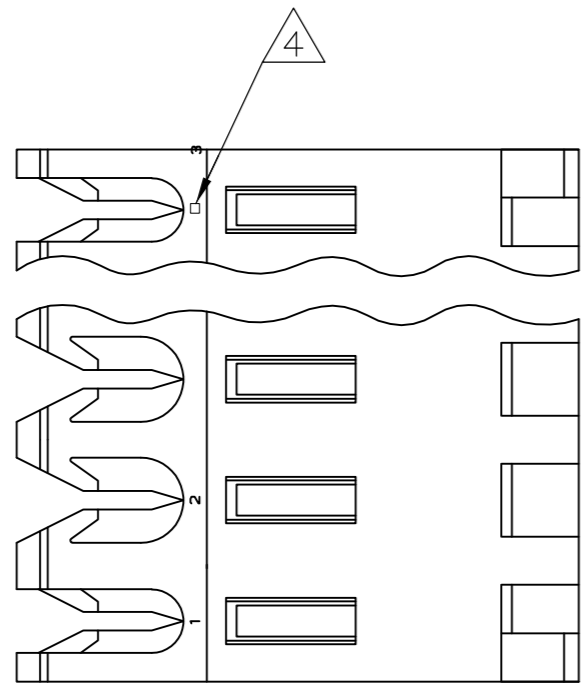

1 MATERIAL:
 CONNECTOR - NYLON UL94V-2 (ORANGE).
 CONTACTS - 0.30[.012] THICK COPPER ALLOY.
 PLATING - 0.00038[.000015] GOLD IN CONTACT AREA.
 0.00203[.000080] MIN THICKNESS BRIGHT TIN LEAD IN SLOT AREA FOR 647479-2 THRU 1-647479-2 OR MATTE WHISKER MITIGATED TIN IN SLOT AREA FOR 3-647479-2 THRU 5-647479-4 OVER NICKEL UNDERPLATE.

- 2. CONTACTS ACCEPT 18 AWG WIRE WITH 2.41[.095] MAX INSULATION DIAMETER.
- 3. CONTACTS MUST ACCEPT 1.14±0.03[.045] POST AND REMAIN LOCKED IN POSITION.
- 4 IDENTIFICATION NUMBER FOR LAST CIRCUIT MAY TIN-LEADT APPEAR ON ALL ASSEMBLIES.
- 5. DIMENSIONS IN BRACKETS ARE IN INCHES.
- 6. HOUSING FEATURES ARE: FEED-THRU WITH LOCKING RAMP AND POLARIZING TAB.

METRIC

FINISH	DIM A	NO. OF CIRCUITS	PART NO.
TIN	47.55[1.872]	12	4-647479-2
TIN	43.59[1.716]	11	4-647479-1
TIN	39.62[1.560]	10	4-647479-0
TIN	35.66[1.404]	9	3-647479-9
TIN	31.70[1.248]	8	3-647479-8
TIN	27.74[1.092]	7	3-647479-7
TIN	23.77[.936]	6	3-647479-6
TIN	19.81[.780]	5	3-647479-5
TIN	15.85[.624]	4	3-647479-4
TIN	11.89[.468]	3	3-647479-3
TIN	7.92[.312]	2	3-647479-2
TIN-LEAD	47.55[1.872]	12	1-647479-2
TIN-LEAD	43.59[1.716]	11	1-647479-1
TIN-LEAD	39.62[1.560]	10	1-647479-0
TIN-LEAD	35.66[1.404]	9	647479-9
TIN-LEAD	31.70[1.248]	8	647479-8
TIN-LEAD	27.74[1.092]	7	647479-7
TIN-LEAD	23.77[.936]	6	647479-6
TIN-LEAD	19.81[.780]	5	647479-5
TIN-LEAD	15.85[.624]	4	647479-4
TIN-LEAD	11.89[.468]	3	647479-3
TIN-LEAD	7.92[.312]	2	647479-2

THIS DRAWING IS A CONTROLLED DOCUMENT.		DWN K. WHITAKER 15-MAR-04	Tyco Electronics Corporation Harrisburg, Pa 17105-3608	
DIMENSIONS: mm [INCHES]		CHK D. BOSSI 15-MAR-04	NAME MTA-156 CONNECTOR ASSEMBLY, 18 AWG, STANDARD	
TOLERANCES UNLESS OTHERWISE SPECIFIED: 0 PLC ± - 1 PLC ± - 2 PLC ± - 3 PLC ± - 4 PLC ± - ANGLES ± -		APVD D. BOSSI 15-MAR-04	SIZE A2	
MATERIAL 1		PRODUCT SPEC 108-1051	CAGE CODE 00779	DRAWING NO C=647479
FINISH 1		APPLICATION SPEC 114-1020	RESTRICTED TO -	SCALE 4:1
CUSTOMER DRAWING		WEIGHT -	SHEET 1 OF 1	REV E